

KEEP MEETINGS MOVING



ENGINEERED
FOR BUSINESS

INTEGRATED, INTERACTIVE MEETING ROOM SYSTEM



No.1 SINCE 2001
EPSON
WORLD LEADER
IN PROJECTORS*1

Transform your business with the all-in-one interactive meeting room system from the world number one in projectors*1. The Epson EB-1400Wi Series enhances collaboration and productivity by combining ultra-short-throw projection, interactive whiteboard, paper flipchart and more in a single device.

The complete integrated solution

Capture content from external sources, share and consolidate using interactive projection and Epson's easy interactive tools, then save, print or e-mail to distribute content effectively.



Change the way you present

These ultra-short-throw projectors eliminate glare and shadows and create perfect images. They make one-sided presenting a thing of the past and maximise audience involvement with real-time annotation and multi-location involvement.



Easy to set up and use

Forget complex multiple devices and training. These projectors are simple to use from start-to-finish. Easy to install in any room, they connect to a wide range of sources, including PCs, mobile devices, wireless office networks and USB flash drives.

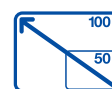

Project big screen images up to 100in from close-up



Easy wireless connection saves set-up time



Annotate directly onto the projected image with dual pens



iProjection app enables wireless projection from both iOS (4.2 or later) and Android™*7 mobile devices



Save presentations/minutes and more directly to USB memory



Send presentations/minutes and more directly via email



Print the meeting memo instantly from the projector

Digital workflow

The Epson EB-1400Wi digital interactive system makes the audience an integral part of the presentation, inspires discussion and enables ideas to be added, saved and shared. The result is a very smooth digital workflow.

- Project big, clear, colourful images with no shadows or glare
- Annotate and enhance presentations with dual interactive pens
- Create an electronic flip chart, then add, copy and delete pages as content is collectively reviewed
- Print documents immediately, either locally or to a network resource
- Save created content locally to USB, to a network location, or share via e-mail
- Take control of all aspects of presenting and manage documents with the control pad

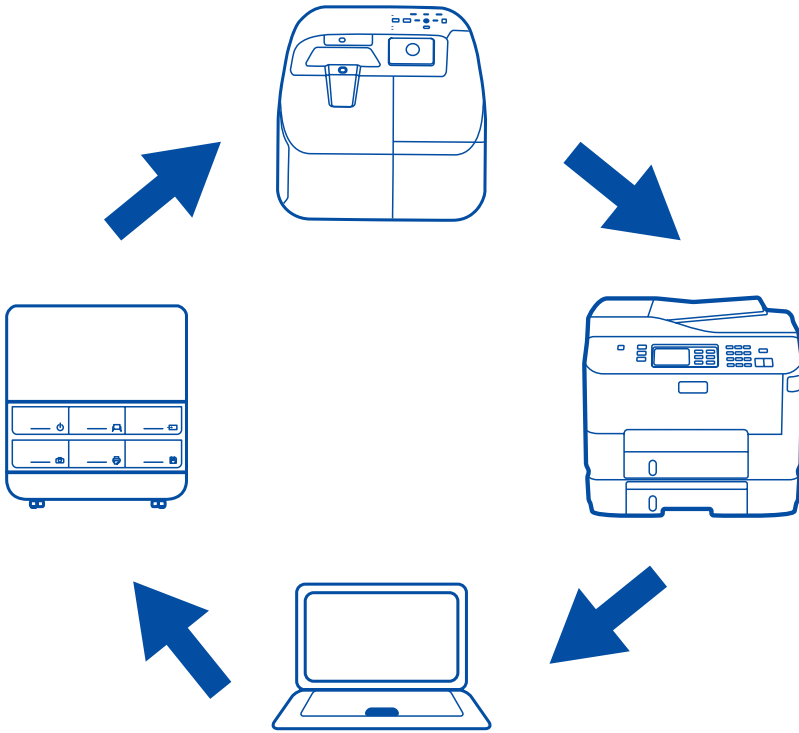

Turn any flat surface interactive

Create a bright, 100in interactive projection surface on a wall or desktop and create the perfect collaborative environment.

- Interactive pen also provides mouse control
- Choose from a range of interactive tools
- Compatible with virtually any PC-based software application
- Four mounting positions (wall, ceiling, desktop and table projection)



SMOOTH DIGITAL WORKFLOW

With the Epson EB-1400Wi Series, information flows clearly and smoothly from screen to viewers, who can then discuss and develop the subject using the interactive features. Results can then be saved via USB, emailed or printed.

The Epson EB-1400Wi Series provides an integrated, interactive digital meeting room system that enables face-to-face, real time communication without the need to travel between locations. Choose how, when and where you share information and ensure the most efficient use of time and resources.

Video conferencing

Share information and involve audiences by projecting information from a PC while holding a video conference on the same screen.

- Interact with other locations whilst viewing common information
- Enhance involvement and understanding by connecting visually with colleagues



Split screen

Project images from two input sources simultaneously and ensure clarity with a screen size up to 100in.

- Enhance staff meetings with interactivity based around applications including Microsoft Office Excel, Word and Powerpoint*2
- Compare and discuss information from different sources at the same time



Multi-location

Share a single PC screen with up to four network connected projectors. Annotations from any one of the four projectors will be displayed on the other three thanks to the EasyMP Network projection software which shares both content and interactivity.

- Collaborate and annotate from remote locations
- Image annotation can be completed from up to four remote locations, using one pen per location



Wireless content delivery

Deliver content wirelessly from a PC or Mobile Device for easy information sharing

- EasyMP Network projection enables users to wirelessly display PC content direct to the projector while maintaining mouse control
- Connect and display content from iOS/Android mobile devices. The iProjection App enables users to deliver mobile device content direct to the projector



Ultra-short-throw projection

Easy installation, no shadow or glare

A collaborative experience

Capture, create, consolidate and share data to support effective collaboration

Low maintenance

Low Total Cost of Ownership (TCO)
Long lamp life up to 4000 hours*3
Maintenance intervals up to 5000 hours*4

Intelligent presenting system

Supporting a fully digital workflow the EB-1400Wi Series combines the benefits of ultra-short-throw projectors, interactive whiteboards, and paper flipcharts in a single integrated system

Easy set-up and operation

Flexible features and intuitive software enable easy operation and effective information sharing

No waiting, no warm-up

Quick Start and Instant Off

Wired/wireless connectivity

Flexible connection makes sharing information simple



Smart information sharing

Display content from a range of sources then save as PDF to USB memory key or network location, print or send via e-mail.

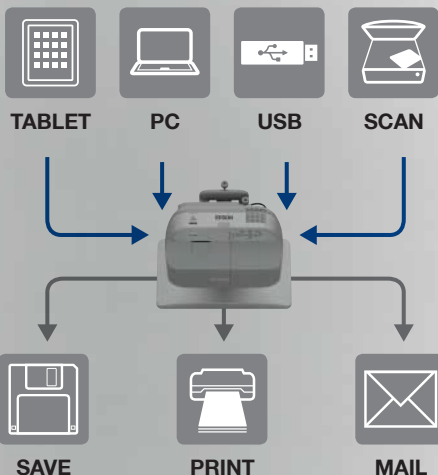

Easy operation control pad



Power On/Source Search/Capture Content from an external source/Print or Save Content (locally or to a network location) at the push of a button.



ADVANCED FEATURES

PRODUCT OVERVIEW

Specifications

	Epson EB-1400Wi	Epson EB-1410Wi
		
Main features		
White and Colour Light Output (CLO)	2600	3100
Resolution	WXGA 1280x800	WXGA 1280x800
Fewer shadows when in use thanks to ultra-short-throw technology	•	•
Large projected image size (Up to 100in)	•	•
Interactive presenting surface with dual pens	•	•
Built-in interactive function provides a digital flipchart or facility to annotate content without a connected PC	•	•
Open PDF files or import content from a document camera or scanner	•	•
Project wirelessly from a PC using EasyMP network projection or from a mobile device using iProjection App for iOS/Android	•	•
Project data and video simultaneously with split screen function	•	•
Print, save or e-mail created content*5	•	•
Share PC content with up to four systems across multiple locations	•	•
Easy operation with control and connection pad	•	•
Auto calibration and auto resolution detection	•	•
Quick Start and Instant Off	•	•
Options		
USB visualiser	Optional	Optional
Table mount	Optional	Optional
Installation		
Tailor made wall mount solution	•	•

*1Futuresource Consulting Ltd. *2Microsoft Office Excel, Word and PowerPoint are registered trademarks of Microsoft Corporation in the United States and/or other countries. *3Expected lamp life when projector is operated in Eco mode. *4When used in the general office environment (the amount of floating dust: 0.04-0.2 mg/m³). Based on Epson's in-house test results. *5Content can be saved as PDF or single page png file. Files may be saved locally to a USB key or to a pre-defined network folder. *6Windows® and Linux® only, driver required for Mac®. *7Android is a trademark of Google Inc.

Integrated business solutions



Dual interactive pens

Add freedom and involvement to business presenting with digital interactive pens that 'write' on the screen.

- Fast response, picks up movement even when hovering
- Annotate projected images with or without a connected PC and save content either locally or to the network*5
- Light, compact and easy to use
- Dual pens for simultaneous annotation
- No drivers required*6



Control pad

Take central, one-touch control of the EB-1400Wi Series system with this versatile multi-function control pad.

- Position on a table or wall
- System or battery powered
- Connect printer/scanner and read data from USB memory key
- Search available input sources
- Select whiteboard mode
- Capture, print or save content



Compatible printers

Add high quality printing with the WorkForce Pro 4000 Series.

- Print, scan, and copy in a single device
- Great value with individual inks
- Compact footprint
- Easy integration into office printer networks

For further information please contact your local Epson office or visit www.epson-europe.com

Austria 0810/20 01 13 (0,07 €/min) **Belgium** 070/350120 (0,1735 €/min) **Czech** 800/142 052 **Denmark** 44 50 85 85
Finland 0201 552 091 **France** 09 74 75 04 04 (Cost of local call, operator charges may apply) **Germany** 01805/23 41 10
(0,14 €/min aus dem dt. Festnetz, Mobilfunkpreise abweichend. Ab 1.3.2010 Mobilfunkpreis max. 0,42 €/min)
Greece 210-8099499 **Hungary** 06800 147 83 **Ireland** 01 436 7742 **Italy** 02-660321 10 (0,12 €/min) **Luxembourg** 900/43010
(0,24 €/min) **Middle East** +9714 8872172 **Netherlands** 0900-5050808 (0,05 €/oproep + 0,15 €/min) **Norway** +47 67 11 37 00
Poland 0-0-800 4911299 (0,16 zł/min) **Portugal** 707 222 111 **Russia** (095) 777-03-55 **Slovakia** 0850 111 429 **South Africa**
(+2711) 465-9621 **Spain** 93 582 15 00 **Sweden** 0771-400135 (Mobilsamtal – 0,99 kr/min, Lokala samtal – 0,30 kr/min,
Utländssamtal – 0,89 kr/min) **Switzerland** 0848 448820 (8 cent./min) **Turkey** (0212) 3360303 **United Kingdom** 0871 222 6702

Trademarks and registered trademarks are the property of Seiko Epson Corporation or their respective owners. Product information is subject to change without prior notice. All images are for illustrative purposes only.

Better Products
for a Better Future™

EPSON®